

SJ3-VR STREAMJET

VARIABLE RATE FLÜSSIGDÜNGERDÜSEN

Die SJ3-VR Produktlinie für die Flüssigdüngung erzielt mittels einer im Durchmesser variablen Elastomer-Dosierblende eine hohe Variabilität des Volumenstroms – „wie fünf Düsen in Einer“. Mit dem auf 7 bar erweiterten Druckbereich kann so ohne Düsenwechsel über größere Geschwindigkeits- und l/ha-Bereiche schlagkräftig gefahren werden, perfekt für die teilflächenspezifische Applikation.

MERKMALE:

- SJ3-VR – drei gleichförmige Strahlen, die direkt auf den Zielbereich ausgerichtet werden
- Gleichgroße Tropfen minimieren die Verätzungsgefahr und praktisch keine Abdrift
- Düsenkörper und Prallteller aus Acetal mit hoher chemischer Festigkeit für lange Lebensdauer
- Einfache, zuverlässige und im Durchmesser variable EPDM-Elastomer-Dosierblende
- Druckbereich 1.5 bis 7.0 bar (20 bis 100 psi)
- VR-Düsen eignen sich nur für die Volumenstromregelung
- Drei verschiedene Düsengrößen decken die üblichen 10 Größen der herkömmlichen SJ3



SJ3-VR-X0.5



SJ3-VR-X1.0



SJ3-VR-X2.0

GESCHWINDIGKEITSBEREICHE FÜR VERSCHIEDENE AUFWANDMENGEN

| Düse | Fahrgeschwindigkeit (km/h) bei Düsenabstand 35 cm | | | | | | | |
|-------------|---|----------|-----------|-----------|-----------|-----------|-----------|-----------|
| | 100 l/ha | 200 l/ha | 300 l/ha | 400 l/ha | 500 l/ha | 600 l/ha | 700 l/ha | 800 l/ha |
| SJ3-VR-X0.5 | 8.7 - 27 | 4.4 - 13 | 2.9 - 8.9 | 2.2 - 6.6 | 1.7 - 5.3 | 1.5 - 4.4 | 1.2 - 3.8 | 1.1 - 3.3 |
| SJ3-VR-X1.0 | 14 - 59 | 7.2 - 29 | 4.8 - 20 | 3.6 - 15 | 2.9 - 12 | 2.4 - 9.8 | 2.1 - 8.4 | 1.8 - 7.4 |
| SJ3-VR-X2.0 | - | - | - | 22 - 63 | 18 - 50 | 15 - 42 | 13 - 36 | 11 - 31 |

l/ha-Werte(Wasser)bei1.5bis7.0bar

| Düse | Fahrgeschwindigkeit (km/h) bei Düsenabstand 50 cm | | | | | | | |
|-------------|---|-----------|-----------|-----------|-----------|-----------|-----------|-----------|
| | 100 l/ha | 200 l/ha | 300 l/ha | 400 l/ha | 500 l/ha | 600 l/ha | 700 l/ha | 800 l/ha |
| SJ3-VR-X0.5 | 6.1 - 19 | 3.1 - 9.3 | 2.0 - 6.2 | 1.5 - 4.7 | 1.2 - 3.7 | 1.0 - 3.1 | 0.9 - 2.7 | 0.8 - 2.3 |
| SJ3-VR-X1.0 | 10 - 41 | 5.0 - 21 | 3.4 - 14 | 2.5 - 10 | 2.0 - 8.3 | 1.7 - 6.9 | 1.4 - 5.9 | 1.3 - 5.2 |
| SJ3-VR-X2.0 | - | 13 - 38 | 8.8 - 25 | 6.6 - 19 | 5.3 - 15 | 4.4 - 13 | 3.8 - 11 | 3.3 - 9.4 |

l/ha-Werte(Wasser)bei1.5bis7.0bar

AUSBRINGTABELLEN (WERTE GELTEN FÜR WASSER)

| Düse | Druck (bar) | Ausstoss 1 Düse (l/min) | l/ha für Düsenabstand 35 cm (Wasser) | | | | | | | | | |
|-------------|-------------|-------------------------|--------------------------------------|---------|---------|---------|---------|---------|---------|---------|---------|---------|
| | | | 8 km/h | 10 km/h | 12 km/h | 14 km/h | 16 km/h | 18 km/h | 20 km/h | 25 km/h | 30 km/h | 35 km/h |
| SJ3-VR-X0.5 | 1.5 | 0.51 | 109 | 87.4 | 72.9 | 62.4 | 54.6 | 48.6 | 43.7 | 35.0 | 29.1 | 25.0 |
| | 2.0 | 0.58 | 124 | 99.4 | 82.9 | 71.0 | 62.1 | 55.2 | 49.7 | 39.8 | 33.1 | 28.4 |
| | 3.0 | 0.71 | 152 | 122 | 101 | 86.9 | 76.1 | 67.6 | 60.9 | 48.7 | 40.6 | 34.8 |
| | 4.0 | 0.87 | 186 | 149 | 124 | 107 | 93.2 | 82.9 | 74.6 | 59.7 | 49.7 | 42.6 |
| | 5.0 | 1.06 | 227 | 182 | 151 | 130 | 114 | 101 | 90.9 | 72.7 | 60.6 | 51.9 |
| | 6.0 | 1.28 | 274 | 219 | 183 | 157 | 137 | 122 | 110 | 87.8 | 73.1 | 62.7 |
| | 7.0 | 1.55 | 332 | 266 | 221 | 190 | 166 | 148 | 133 | 106 | 88.6 | 75.9 |
| SJ3-VR-X1.0 | 1.5 | 0.84 | 180 | 144 | 120 | 103 | 90.0 | 80.0 | 72.0 | 57.6 | 48.0 | 41.1 |
| | 2.0 | 1.02 | 219 | 175 | 146 | 125 | 109 | 97.1 | 87.4 | 69.9 | 58.3 | 50.0 |
| | 3.0 | 1.41 | 302 | 242 | 201 | 173 | 151 | 134 | 121 | 96.7 | 80.6 | 69.1 |
| | 4.0 | 1.84 | 394 | 315 | 263 | 225 | 197 | 175 | 158 | 126 | 105 | 90.1 |
| | 5.0 | 2.33 | 499 | 399 | 333 | 285 | 250 | 222 | 200 | 160 | 133 | 114 |
| | 6.0 | 2.86 | 613 | 490 | 409 | 350 | 306 | 272 | 245 | 196 | 163 | 140 |
| | 7.0 | 3.44 | 737 | 590 | 491 | 421 | 369 | 328 | 295 | 236 | 197 | 168 |
| SJ3-VR-X2.0 | 1.5 | 2.19 | 469 | 375 | 313 | 268 | 235 | 209 | 188 | 150 | 125 | 107 |
| | 2.0 | 2.58 | 553 | 442 | 369 | 316 | 276 | 246 | 221 | 177 | 147 | 126 |
| | 3.0 | 3.36 | 720 | 576 | 480 | 411 | 360 | 320 | 288 | 230 | 192 | 165 |
| | 4.0 | 4.11 | 881 | 705 | 587 | 503 | 440 | 391 | 352 | 282 | 235 | 201 |
| | 5.0 | 4.85 | 1039 | 831 | 693 | 594 | 520 | 462 | 416 | 333 | 277 | 238 |
| | 6.0 | 5.58 | 1196 | 957 | 797 | 683 | 598 | 531 | 478 | 383 | 319 | 273 |
| | 7.0 | 6.29 | 1348 | 1078 | 899 | 770 | 674 | 599 | 539 | 431 | 359 | 308 |

| Düse | Druck (bar) | Ausstoss 1 Düse (l/min) | l/ha für Düsenabstand 50 cm (Wasser) | | | | | | | | | |
|-------------|-------------|-------------------------|--------------------------------------|---------|---------|---------|---------|---------|---------|---------|---------|---------|
| | | | 8 km/h | 10 km/h | 12 km/h | 14 km/h | 16 km/h | 18 km/h | 20 km/h | 25 km/h | 30 km/h | 35 km/h |
| SJ3-VR-X0.5 | 1.5 | 0.51 | 76.5 | 61.2 | 51.0 | 43.7 | 38.3 | 34.0 | 30.6 | 24.5 | 20.4 | 17.5 |
| | 2.0 | 0.58 | 87.0 | 69.6 | 58.0 | 49.7 | 43.5 | 38.7 | 34.8 | 27.8 | 23.2 | 19.9 |
| | 3.0 | 0.71 | 107 | 85.2 | 71.0 | 60.9 | 53.3 | 47.3 | 42.6 | 34.1 | 28.4 | 24.3 |
| | 4.0 | 0.87 | 131 | 104 | 87.0 | 74.6 | 65.3 | 58.0 | 52.2 | 41.8 | 34.8 | 29.8 |
| | 5.0 | 1.06 | 159 | 127 | 106 | 90.9 | 79.5 | 70.7 | 63.6 | 50.9 | 42.4 | 36.3 |
| | 6.0 | 1.28 | 192 | 154 | 128 | 110 | 96.0 | 85.3 | 76.8 | 61.4 | 51.2 | 43.9 |
| | 7.0 | 1.55 | 233 | 186 | 155 | 133 | 116 | 103 | 93.0 | 74.4 | 62.0 | 53.1 |
| SJ3-VR-X1.0 | 1.5 | 0.84 | 126 | 101 | 84.0 | 72.0 | 63.0 | 56.0 | 50.4 | 40.3 | 33.6 | 28.8 |
| | 2.0 | 1.02 | 153 | 122 | 102 | 87.4 | 76.5 | 68.0 | 61.2 | 49.0 | 40.8 | 35.0 |
| | 3.0 | 1.41 | 212 | 169 | 141 | 121 | 106 | 94.0 | 84.6 | 67.7 | 56.4 | 48.3 |
| | 4.0 | 1.84 | 276 | 221 | 184 | 158 | 138 | 123 | 110 | 88.3 | 73.6 | 63.1 |
| | 5.0 | 2.33 | 350 | 280 | 233 | 200 | 175 | 155 | 140 | 112 | 93.2 | 79.9 |
| | 6.0 | 2.86 | 429 | 343 | 286 | 245 | 215 | 191 | 172 | 137 | 114 | 98.1 |
| | 7.0 | 3.44 | 516 | 413 | 344 | 295 | 258 | 229 | 206 | 165 | 138 | 118 |
| SJ3-VR-X2.0 | 1.5 | 2.19 | 329 | 263 | 219 | 188 | 164 | 146 | 131 | 105 | 87.6 | 75.1 |
| | 2.0 | 2.58 | 387 | 310 | 258 | 221 | 194 | 172 | 155 | 124 | 103 | 88.5 |
| | 3.0 | 3.36 | 504 | 403 | 336 | 288 | 252 | 224 | 202 | 161 | 134 | 115 |
| | 4.0 | 4.11 | 617 | 493 | 411 | 352 | 308 | 274 | 247 | 197 | 164 | 141 |
| | 5.0 | 4.85 | 728 | 582 | 485 | 416 | 364 | 323 | 291 | 233 | 194 | 166 |
| | 6.0 | 5.58 | 837 | 670 | 558 | 478 | 419 | 372 | 335 | 268 | 223 | 191 |
| | 7.0 | 6.29 | 944 | 755 | 629 | 539 | 472 | 419 | 377 | 302 | 252 | 216 |

Hinweis: Druck an der Düse; Tabellenwert durch Auslitern prüfen. Ausbringmengen gelten für Wasser (21°C / 70°F).

BESTELLDATEN:

Beispiel:

| ART.-NR. | BESCHREIBUNG |
|-------------|--------------------------|
| SJ3-VR-X2.0 | SJ3-VR Flüssigdüngerdüse |

| DICHTE | DICHTE (kg/l) | KORREKTURFAKTOREN |
|----------------|-----------------------|-------------------|
| 7.0 lbs./gal | 0.84 | 0.92 |
| 8.0 lbs./gal | 0.96 | 0.98 |
| 8.34 lbs./gal | 1.00 - WASSER | 1.00 |
| 9.0 lbs./gal | 1.08 | 1.04 |
| 10.0 lbs./gal | 1.20 | 1.10 |
| 10.65 lbs./gal | 1.28 - 28% STICKSTOFF | 1.13 |
| 11.0 lbs./gal | 1.32 | 1.15 |
| 12.0 lbs./gal | 1.44 | 1.20 |
| 14.0 lbs./gal | 1.68 | 1.30 |

*Hinweis: Die Korrekturfaktoren bei Flüssigkeiten verwenden, deren Dichte von Wasser abweicht. Dazu den Wert (l/ha oder l/min) des Flüssigdüngers mit dem entsprechenden Korrekturfaktor multiplizieren, den errechneten Wert in nebenstehender Tabelle einsetzen und die übrigen Parameter heraus lesen.

| OPTIMALE SPRITZHÖHE | |
|---------------------|------------|
| DÜSENABSTAND | SPRITZHÖHE |
| 50 cm | 50 cm |
| 75 cm | 75 cm |
| 100 cm | 100 cm |

*Optimalerweise ein Verhältnis von 1:1 für Spritzhöhe zu Düsenabstand wählen.

SJ3-VR-X1.0 VARIABLE RATE STREAMJET

FEATURES:

- DESIGNED FOR USE IN FLOWMETER-BASED APPLICATION SYSTEMS
- CREATES THREE IDENTICAL FLUID STREAMS OF EQUAL VELOCITY AND CAPACITY
- EXCELLENT SPRAY DISTRIBUTION QUALITY
- REMOVABLE VARIABLE RATE ORIFICE (EPDM) FOR EASY CLEANING
- VARIABLE RATE FOR A WIDE RANGE OF APPLICATION SPEEDS AND RATES
- NYLON, ACETAL & EPDM CONSTRUCTION FOR EXCELLENT CHEMICAL RESISTANCE
- RECOMMENDED OPERATING PRESSURE: 1.5 - 7.0 BAR (20 - 100 PSI) FOR OPTIMUM STREAM PERFORMANCE

TYPICAL APPLICATIONS:

- EXCELLENT FOR VARIABLE RATE APPLICATION OF LIQUID FERTILIZER
- EXCELLENT FOR MAINTAINING A FIXED RATE OVER A WIDE RANGE OF SPEEDS

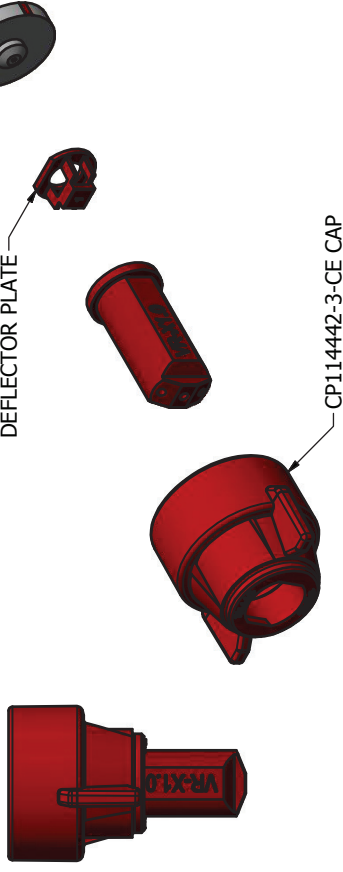

| TIP NO. (STRAINER MESH SIZE) | LIQUID PRESSURE IN BAR | CAPACITY 1 NOZZLE IN L/MIN | 50 CM SPACING | | | | | | | |
|------------------------------------|------------------------------|----------------------------------|--------------------|---------|---------|---------|---------|---------|---------|---------|
| | | | LITERS PER HECTARE | | | | | | | |
| | | | 8 KM/H | 10 KM/H | 12 KM/H | 16 KM/H | 20 KM/H | 25 KM/H | 30 KM/H | 35 KM/H |
| SJ3-VR-X1.0 (50) | 1.5 | 0.84 | 126 | 101 | 84.0 | 63.0 | 50.4 | 40.3 | 33.6 | 28.8 |
| | 2.0 | 1.02 | 153 | 122 | 102 | 76.5 | 61.2 | 49.0 | 40.8 | 35.0 |
| | 2.5 | 1.21 | 182 | 145 | 121 | 90.8 | 72.6 | 58.1 | 48.4 | 41.5 |
| | 3.0 | 1.41 | 212 | 169 | 141 | 106 | 84.6 | 67.7 | 56.4 | 48.3 |
| | 3.5 | 1.62 | 243 | 194 | 162 | 122 | 97.2 | 77.8 | 64.8 | 55.5 |
| | 4.0 | 1.84 | 276 | 221 | 184 | 138 | 110 | 88.3 | 73.6 | 63.1 |
| 5.0 | 2.33 | 350 | 280 | 233 | 175 | 140 | 112 | 93.2 | 79.9 | |
| 6.0 | 2.86 | 429 | 343 | 286 | 215 | 172 | 137 | 114 | 98.1 | |
| 7.0 | 3.44 | 516 | 413 | 344 | 258 | 206 | 165 | 138 | 118 | |

* APPLICATION DATA IS BASED ON SPRAYING WATER AT 21 DEG C (70 DEG F).

* DEFLECTOR PLATE REQUIRED TO MAINTAIN PUBLISHED FLOW RATES AND STEADY STREAM.

* NOTE: FOR 35 CM TIP SPACING MULTIPLY CHART VALUES BY 1.43.

FOR 75 CM TIP SPACING MULTIPLY CHART VALUES BY 0.67.

* SEE DS50050M FOR ADDITIONAL INFORMATION ON SJ3 FIXED RATE STREAMJET.

| OPTIMUM SPRAY HEIGHT | |
|----------------------|--------------|
| NOZZLE SPACING | SPRAY HEIGHT |
| 50 CM | 50 CM |
| 75 CM | 75 CM |
| 100 CM | 100 CM |

* FOR BEST SPRAY DISTRIBUTION MAINTAIN A 1:1 RATIO OF TIP HEIGHT TO TIP SPACING.

FERTILIZER SPECIFIC GRAVITY CONVERSION FACTORS:

| DENSITY OF SOLUTION | CONVERSION FACTOR |
|---------------------|-------------------|
| 0.84 KG/L | 0.92 |
| 0.96 KG/L | 0.98 |
| 1.00 - WATER | 1.00 |
| 1.08 KG/L | 1.04 |
| 1.20 KG/L | 1.10 |
| 1.28 - 28% NITROGEN | 1.13 |
| 1.32 KG/L | 1.15 |
| 1.44 KG/L | 1.20 |
| 1.68 KG/L | 1.30 |

NOTE: CONVERSION FACTORS MUST BE USED WHEN SPRAYING SOLUTIONS HEAVIER OR LIGHTER THAN WATER. FIRST, MULTIPLY DESIRED APPLICATION RATE BY THE APPROPRIATE CONVERSION FACTOR ABOVE. THEN USE THE NEW APPLICATION RATE TO SELECT THE MOST APPROPRIATE OPERATING PRESSURE FROM THE APPLICATION CHART ON THIS PAGE.

DESCRIPTION:

APPLICATION RATES
FOR SJ3-VR-X1.0
VARIABLE RATE
3-ORIFICE FERTILIZER
NOZZLE (METRIC)

REVISION NO. 3

REFERENCE: 3/16/17

DATASHEET
DSSJ3-VR-X1.0M

SHEET: _____

B