



TB2001

## TRACTOR SERVICE INFO

Part Nr. 333 0170 11 – 330mm TDCA – 17 Spline

STEYR – M9078, M9083, M9086, M9094

CASE IH – CS78, CS86, CS94

Info: 333 0170 11 replaces / ersetzt / remplace / sustituye a / sostituisce 333 0136 10 and 333 0170 10



633 3008 09 = 233 0034 10 + 333 0170 11

633 3008 10 = 233 0034 10 + 333 0170 11 + 500 0058 10 + 500 0059 10 + 410 00133 40

633 3008 11 = 233 0034 12 + 333 0170 16 + 500 0058 10 + 500 0059 10 + 410 00133 40

633 3008 19 = 233 0034 12 + 333 0170 16



Re-machine the flywheel inner recess to a diameter of  $185 \pm 0.5$  mm and a depth of 8 mm to avoid rivet contacting flywheel.



Um zu verhindern, dass die Nieten mit dem Schwungrad in Berührung kommen, muss die innere Vertiefung des Schwungrades auf einen Durchmesser von  $185 \pm 0.5$  mm und eine Tiefe von 8 mm nachgearbeitet werden.



Ré-usinez la cavité intérieure du volant-moteur de sorte à obtenir un diamètre de  $185 \pm 0.5$  mm et une profondeur de 8 mm pour éviter que le rivet ne touche le volant-moteur.



Rectifique el hueco interior del volante-motor con un diámetro de  $185 \pm 0.5$  mm y una profundidad de 8 mm, con el fin de evitar que entre en contacto con los remaches.



Rettificare nuovamente la cavità interna del volano a un diametro di  $185 \pm 0.5$  mm e una profondità di 8 mm per evitare che il rivetto entri in contatto con il volano.

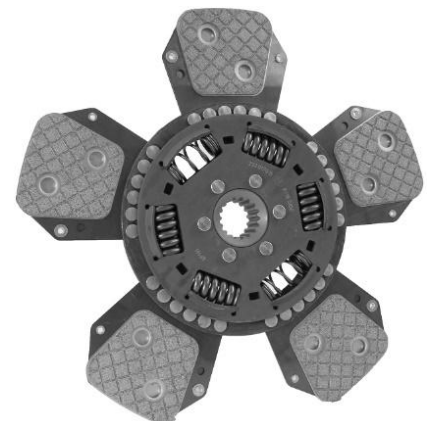
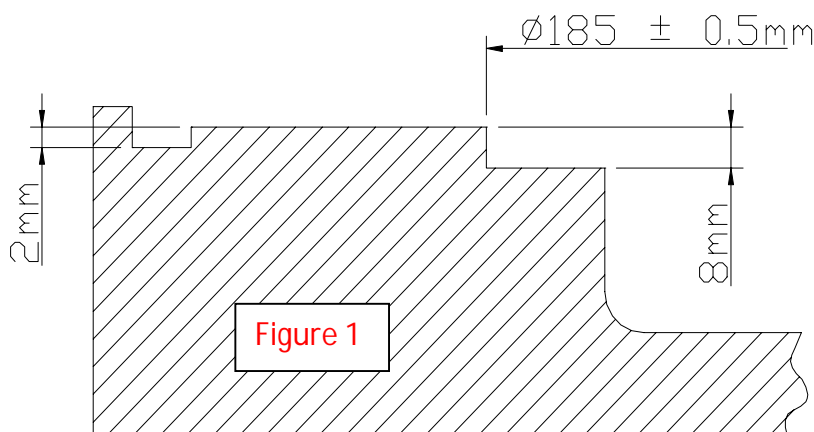

Call : +44 (0) 1432 264264  
 Fax : +44 (0) 1432 375 760  
 aftermarket.uk@schaeffler.com  
 www.repxpert.co.uk

SCHAEFFLER  
**REP>XPERT**



# TRACTOR SERVICE INFO



TB2001

**Clutch housing location using flywheel step of 2mm. See Figure 1**

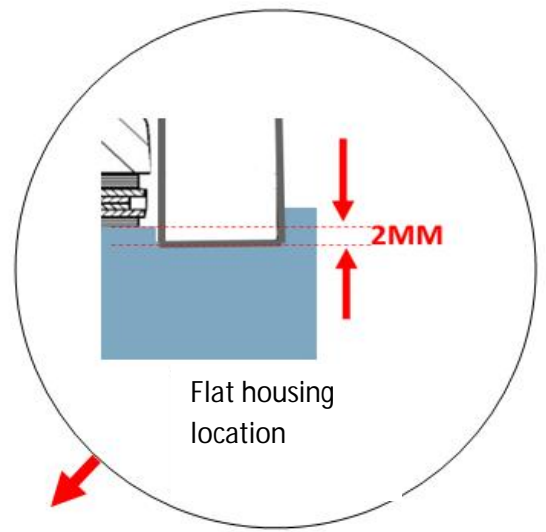
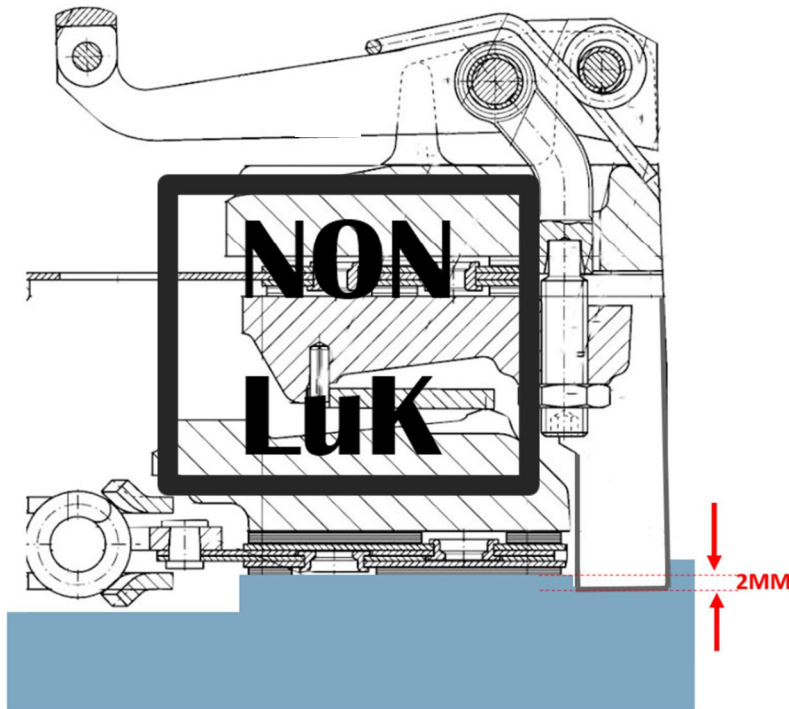
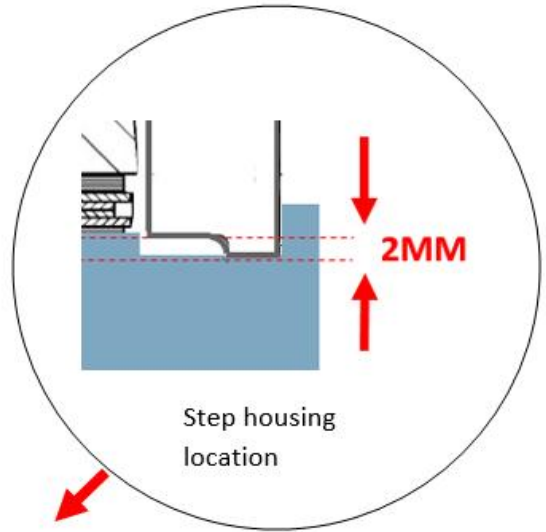
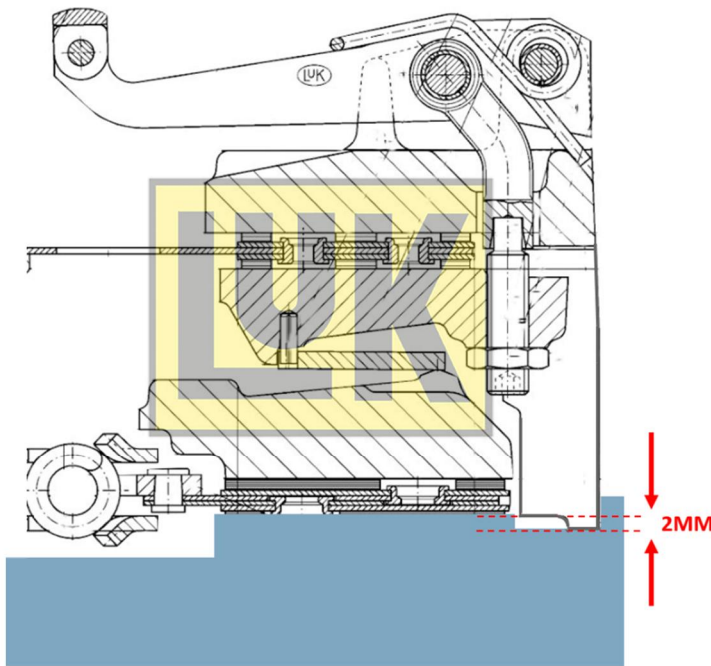

Issued 05.2020 / TB2001 / Technical content subject to change  
 OE Manufacturers names and numbers are used for reference purposes only  
 © Schaeffler Automotive Aftermarket

Call : +44 (0) 1432 264264  
 Fax : +44 (0) 1432 375 760  
 aftermarket.uk@schaeffler.com  
 www.repxpert.co.uk